



Doldon W. Moore, Jr.  
Wetlands Administrator

State of Maryland  
**Board of Public Works**

Wetlands Administration  
Post Office Box 1510  
Annapolis, Maryland 21404  
410-260-7791  
Fax: 410-974-5240  
Toll Free: 1-877-591-7320

Martin O'Malley  
Governor

Nancy K. Kopp  
Treasurer

Peter Franchot  
Comptroller

Sheila C. McDonald  
Executive Secretary

April 18, 2012

Little Magothy River Assoc.  
c/o BayLand Consultants  
1321 Mercedes Dr., Ste. A  
Hanover, MD 21076

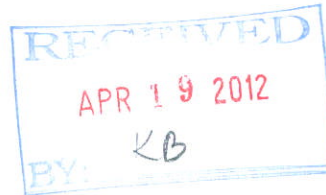

Dear Applicant(s):

RE: Wetlands License No. 12-0590, Magothy/Little Magothy rivers, AACounty

Enclosed please find the original and one copy of the above-mentioned wetlands license issued to you on April 18, 2012.

After you have read all the conditions of the license, please ensure that the license is signed by the named licensee and the entire original (including plans) is returned to this office within 15 days in the enclosed envelope. Please retain the copy of the license for your records. This license is valid for a period of six years, as indicated on page three.

Please note that you must notify the MD Department of the Environment, Inspections and Compliance Program, by calling (410) 537-3510 in Baltimore, or (410) 901-4020 in Cambridge, prior to commencing work.

This does not constitute your federal authorization. Please contact the U.S. Army Corps of Engineers, Baltimore District, at (410) 962-4500 (Maryland Section Southern) or (410) 962-4252 (MD Section Northern) regarding the status of the federal permit, if it has not been received.

If you have any questions concerning any of the terms and conditions of the attached license, please contact me at the address or telephone number shown above.

Sincerely,

Doldon W. Moore, Jr.  
Wetlands Administrator

Enclosure

cc: MDE, Tidal Wetlands Division

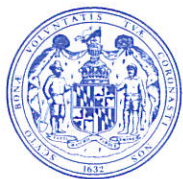

Doldon W. Moore, Jr.  
*Wetlands Administrator*

State of Maryland  
**Board of Public Works**

Wetlands Administration  
Post Office Box 1510  
Annapolis, Maryland 21404  
410-260-7791  
Fax: 410-974-5240  
Toll Free: 1-877-591-7320

Martin O'Malley  
*Governor*

Nancy K. Kopp  
*Treasurer*

Peter Franchot  
*Comptroller*

Sheila C. McDonald  
*Executive Secretary*

**WETLANDS LICENSE NO. 12-0590**

**LITTLE MAGOTHY RIVER ASSOCIATION**

In response to an application dated February 3, 2012, for a Wetlands License, upon the recommendation of the Wetlands Administrator of the Board of Public Works, and pursuant to the provisions of Title 16, Environment Article, Annotated Code of Maryland (1996 Repl. Vol. and Supplement), entitled "Wetlands and Riparian Rights," enacted to provide a State policy for the preservation of wetlands and regulation of the filling and dredging of wetlands in Maryland, and for other purposes, you are hereby authorized by the Board of Public Works, for the State of Maryland to:

“Hydraulically/mechanically maintenance dredge a 1,731-foot long by 25 to 65-foot wide main channel to the 5 to 6-foot depth at mean low water, transport 6,000 cubic yards of dredged material to the approved upland dredged material disposal site known as Crandell’s DMP off Browns Way in Anne Arundel County, and to provide for periodic maintenance dredging for six years.”

*At the confluence of the Magothy River and the Little Magothy River near Annapolis in Anne Arundel County*

This license is subject to the following special conditions:

- A. All work shall be permitted under, and performed in accordance with, the Critical Area requirements of the local jurisdiction where the project is located. This authorization does not constitute authorization for disturbance in the 100-foot Critical Area Buffer. “Disturbance” in the Buffer means clearing, grading, construction activities, or removal of any size of tree or vegetation. Any anticipated Buffer disturbance requires prior written approval, before commencement of land-disturbing activity, from the local jurisdiction in the form of a Buffer Management Plan.
- B. All work shall be performed in accordance with the required Soil Erosion and Sediment Control Plan as approved by the Anne Arundel County Soil Conservation District.
- C. All work shall be performed in accordance with the required Water Quality Certification issued by the Maryland Department of the Environment and in accordance with the Maryland State Programmatic General Permit (MDSPPG-3) or the U.S. Army Corps of Engineers’ Individual Authorization.

- D. No marsh shall be filled, dredged, or otherwise altered or destroyed.
- E. The Maryland Department of Environment has determined that the proposed activity complies with, and will be conducted in a manner consistent with, the State's Coastal Zone Management Program, as required by Section 307 of the Federal Coastal Zone Management Act of 1972, as amended.
- F. All work performed under this tidal wetlands license shall be conducted by the property owner or by a marine contractor registered with the Maryland Department of the Environment in accordance with Chapter 286 of the 2010 Laws of Maryland. A list of registered marine contractors can be obtained by contacting the Department at 410-537-3837 or by visiting the department's website at: [http://www.mde.state.md.us/programs/water/wetlandsandwaterways/documents/marinecontractor\\_registered\\_list.pdf](http://www.mde.state.md.us/programs/water/wetlandsandwaterways/documents/marinecontractor_registered_list.pdf).
- G. For the portion of the entrance channel located in the Magothy River, no dredging shall be performed from December 15 through October 15 of any year regardless of the method of dredging.
- H. For the portion of the entrance channel located inside the Little Magothy River, no dredging shall be performed from February 15 through October 15 of any year regardless of the method of dredging.
- I. Maintenance Dredging:
  - 1) Subsequent maintenance dredging shall be done within the scope of the work licensed in terms of area and depths involved.
  - 2) No more than 500 cubic yards of material shall be dredged at each maintenance dredging.
  - 3) Subsequent maintenance dredging shall be in compliance with all applicable conditions of this license.
  - 4) Detailed dredged material disposal plans shall be submitted to and approved by the Water Management Administration, Tidal Wetlands Division, prior to the start of dredging.
  - 5) The Water Management Administration, Inspections and Compliance Program, shall be notified of and approve each maintenance dredging operation a minimum of 10 days prior to the start of dredging (410-537-3510).
  - 6) Dredge material that is mechanically removed from the waterway shall only be transported in watertight trucks. No dredge material shall be discharged onto the roadways of the State.

Tidal Wetlands License No. 12-0590  
Little Magothy River Association  
April 18, 2012

- 1A -

- 7) If hydraulic dredging is performed, the dredged material placement site shall be constructed to limit suspended solids content in the discharge waters of this State to four hundred (400) parts per million or less. A solids sample of the discharge water shall be performed every hour or when there is an observed change in the clarity of the water. The dredger shall have a person at the discharge point of the placement site in constant radio communication. If a problem is incurred, the dredging operation shall shut down until the reason for the problem can be ascertained and rectified.

The authorized work is to be accomplished in accordance with the plans and drawings attached hereto, dated January 26, 2012.

This license is subject to the following general conditions and is revocable or subject to modification prior to the completion of the project as described above when such action is deemed to be in the State's interest.

This license is subject to the following standard conditions:

- a. This license does not authorize a trespass or infringement upon private or public property rights or interests, nor does it relieve the licensee of the obligation to obtain applicable federal, State, or local approvals.
- b. The legal requirements of all federal, State, and local agencies shall be met.
- c. The license does not transfer a property interest of the State unless expressly stated by the Board of Public Works (usually in a separate document).
- d. The licensee shall allow full and free use by the public of State wetlands and navigable waters.
- e. A copy of this license and the plans or drawings attached hereto shall be available at the site until the construction or activity is complete.
- f. The licensee shall submit written notification to the Inspections and Compliance Program of the MD Department of the Environment at least 10 days in advance of commencing the construction or activity, and shall furnish written notification of the date of its completion within 30 days.
- g. The licensee consents to reasonable inspections by representatives of the Board of Public Works or the MD Department of the Environment to ensure consistency with the conditions of the license.
- h. The licensee shall comply promptly with any lawful regulations, conditions, or site complaints and orders affecting the structure or activity authorized herein, if and when issued by the MD Department of the Environment, which is authorized to enforce this license.
- i. The licensee shall maintain the structure authorized herein in good condition or perform the activity in accordance with the approved plans or drawings and otherwise comply with all license provisions until the structure is removed or the activity permanently ceases.
- j. The Board of Public Works or the Wetlands Administrator may modify, suspend, or revoke this license as necessary to protect the State's interests. The decision to modify, suspend, or revoke the license shall be based upon a consideration of the ecological, economic, developmental, recreational, and aesthetic values involved as they may affect the public and proprietary interests of the State.

- k. Any modification, suspension, or revocation of this license shall not be the basis for a claim for damages against the State of Maryland, or any unit or agency of the State.
- l. All provisions of this license shall be binding on any assignee or successor in interest of the licensee, with the procedure for assignment or transfer set by the Board of Public Works.
- m. The licensee or any successor or assignee agrees to make every reasonable effort to construct the structure or perform the activity authorized herein in a workmanlike manner so as to eliminate or minimize any adverse effects of the construction or activity on fish, wildlife and natural environmental values.
- n. The licensee agrees to indemnify, defend and save harmless the State of Maryland, its elected officials, officers and employees from and against any and all liability, suits, claims and actions of whatsoever kind, caused by or arising from the placement of fill and/or piles or construction of structures in the waters of the State pursuant to this wetlands license.
- o. If the structure or activity authorized herein is not completed on or before the 18th day of April, 2018, this license, if not previously revoked or specifically extended, shall cease and be null and void. **NOTE:** In most cases, a 3-year license may be renewed for one additional 3-year period if the request is received prior to the expiration date; 6-year licenses cannot be renewed and licensee must reapply to the Maryland Department of Environment.

By the authority of the Board of Public Works:

Issued for and in behalf of  
the Members of the Board

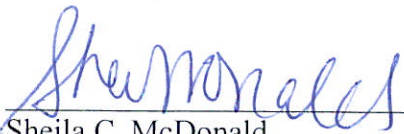
  
\_\_\_\_\_  
Sheila C. McDonald  
Executive Secretary

Effective Date: April 18, 2012

The terms and conditions of this license are hereby accepted.

\_\_\_\_\_  
Date

\_\_\_\_\_  
Licensee (Signature)

\_\_\_\_\_  
Printed Name

**Approved by the Board of  
Public Works on the 18th day  
of April, 2012, as Item 4 on  
the Secretary's Agenda.**



# MARYLAND DEPARTMENT OF THE ENVIRONMENT

1800 Washington Boulevard • Baltimore MD 21230

410-537-3000 • 1-800-633-6101 • www.mde.state.md.us

Martin O'Malley  
Governor

Robert M. Summers, Ph.D.  
Secretary

Anthony G. Brown  
Lieutenant Governor

## WATER QUALITY CERTIFICATION for WETLAND LICENSE 12-WL-0590

**Tracking Number: 201260167**

**Issued to:** LITTLE MAGOTHY RIVER ASSOCIATION/AMY JURAS  
C/o Bayland Consultants & Designers, Inc./Kendra Burnett  
1321 Mercedes Drive, Suite A  
Hanover, MD 21076

**Description of Certified Project:** *To hydraulically/mechanically maintenance dredge a 1,731-foot long by 25 to 65-foot wide main channel to the 5 to 6-foot depth at mean low water, transport 6,000 cubic yards of dredged material to the approved upland dredged material disposal site known as Crandell's DMP off Browns Way in Anne Arundel County, and to provide for periodic maintenance dredging for six years. The project is located at the confluence of the Magothy River and the Little Magothy River near Annapolis, Anne Arundel County, Maryland.*

This water quality certification is issued under authority of Section 401 of the Federal Water Pollution Control Act and its Amendments and the Environment Article, Sections 9-313 to 9-323, inclusive, Annotated Code of Maryland. A copy of this required certification has been sent to the Corps of Engineers. This certification does not relieve the applicant of responsibility for obtaining any other approvals, licenses or permits in accordance with federal, State, or local requirements and does not authorize commencement of the proposed project. The Maryland Department of the Environment has determined from a review of the plans that the project described above will not violate Maryland's water quality standards, provided that the following conditions are satisfied.

The certification holder shall comply with the conditions listed below.

### GENERAL CONDITIONS

1. The proposed project shall be constructed in a manner that will not violate Maryland's Water Quality Standards as set forth in COMAR 26.08.02. The applicant is to notify this department ten (10) days prior to commencing work. Verbal notification is to be followed by written notice within ten (10) days.
2. The proposed project shall be constructed in accordance with the plan and its revisions.
3. All fill and construction materials not used in the project shall be removed and disposed of in a manner that will prevent their entry into waters of this State.
4. The certification holder shall notify the Water Management Administration, Tidal Wetlands Division, in writing, upon transferring property ownership or responsibility for compliance with these conditions to another person. The new owner/operator shall request, in writing, transfer of this water quality certification to his/her name.



5. The certification holder shall allow the Maryland Department of the Environment or its representative to inspect the project area at reasonable times and to inspect records regarding this project.

### SPECIAL CONDITIONS

- A. All works shall be performed in accordance with the required Soil Erosion and Sediment Control plan as approved by the Anne Arundel County Soil Conservation District.
- B. All work shall be permitted under, and in accordance with, the Critical Area requirements of the local jurisdiction where the project is located. This authorization does not constitute authorization for disturbance in the 100-foot Critical Area Buffer. "Disturbance" in the Buffer means clearing, grading, construction activities, or removal of any size of tree or vegetation. Any anticipated Buffer disturbance requires prior written approval, before commencement of land disturbing activity, from the local jurisdiction in the form of a Buffer Management Plan.
- C. The Maryland Department of the Environment has determined that the proposed activities comply with, and will be conducted in a manner consistent with, the State's Coastal Zone Management Program, as required by Section 307 of the Federal Coastal Zone Management Act of 1972, as amended.
- D. All work performed under this tidal wetlands license shall be conducted by THE PROPERTY OWNER OR BY A MARINE CONTRACTOR REGISTERED WITH THE MARYLAND DEPARTMENT OF THE ENVIRONMENT in accordance with Chapter 286 of the 2010 Laws of MARYLAND. A LIST OF REGISTERED MARINE CONTRACTORS CAN BE OBTAINED BY CONTACTING THE DEPARTMENT AT 410-537-3837 OR BY VISITING THE DEPARTMENT'S WEB PAGE AT [http://WWW.MDE.STATE.MD.US/PROGRAMS/WATER/WETLANDS.AND/WATERWAYS/DOCUMENTS/MARINE CONTRACTOR REGISTERED LIST.PDF](http://WWW.MDE.STATE.MD.US/PROGRAMS/WATER/WETLANDS.AND/WATERWAYS/DOCUMENTS/MARINE_CONTRACTOR_REGISTERED_LIST.PDF).
- E. For the portion of the entrance channel located in the Magothy River, no dredging shall be performed between December 15 and October 15 of any year regardless of the method of dredging.
- F. For the portion of the entrance channel located inside the Little Magothy River no dredging shall be performed between February 15 and October 15 of any year regardless of the method of dredging.
- G. If mechanical dredging is performed all dredged material shall be transported in water tight trucks. No dredged material shall be discharged on the roadways of this State.
- H. If hydraulic dredging is performed detailed dredged material disposal plans shall be submitted to and approved by the Water Management Administration, Tidal Wetlands Division prior to the commencement of work.
- I. If hydraulic dredging is performed the upland dredged material disposal site discharge to waters of this State shall be limited to four hundred (400) parts per million or less.
- J. Subsequent maintenance dredging shall be done within the scope of the work licensed in terms of area and depths involved. No more than 500 cubic yards of material shall be dredged at each maintenance dredging.
- K. Subsequent maintenance dredging shall be in compliance with all applicable conditions of this license.
- L. The Water Management Administration, Compliance Program shall be notified of and approve each maintenance dredging operation prior to initiating the dredging.

Failure to comply with these conditions shall constitute reason for suspension or revocation of the Water Quality Certification and legal proceedings may be instituted against the certification holder in accordance with the Annotated Code



of Maryland. In granting this certification, the Department reserves the right to inspect the operations and records regarding this project at anytime.

**CERTIFICATION APPROVED**

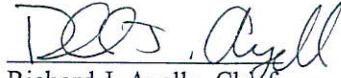

Richard J. Ayella, Chief  
Tidal Wetlands Division

3/21/18

Expiration Date

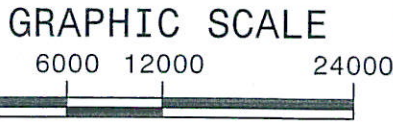
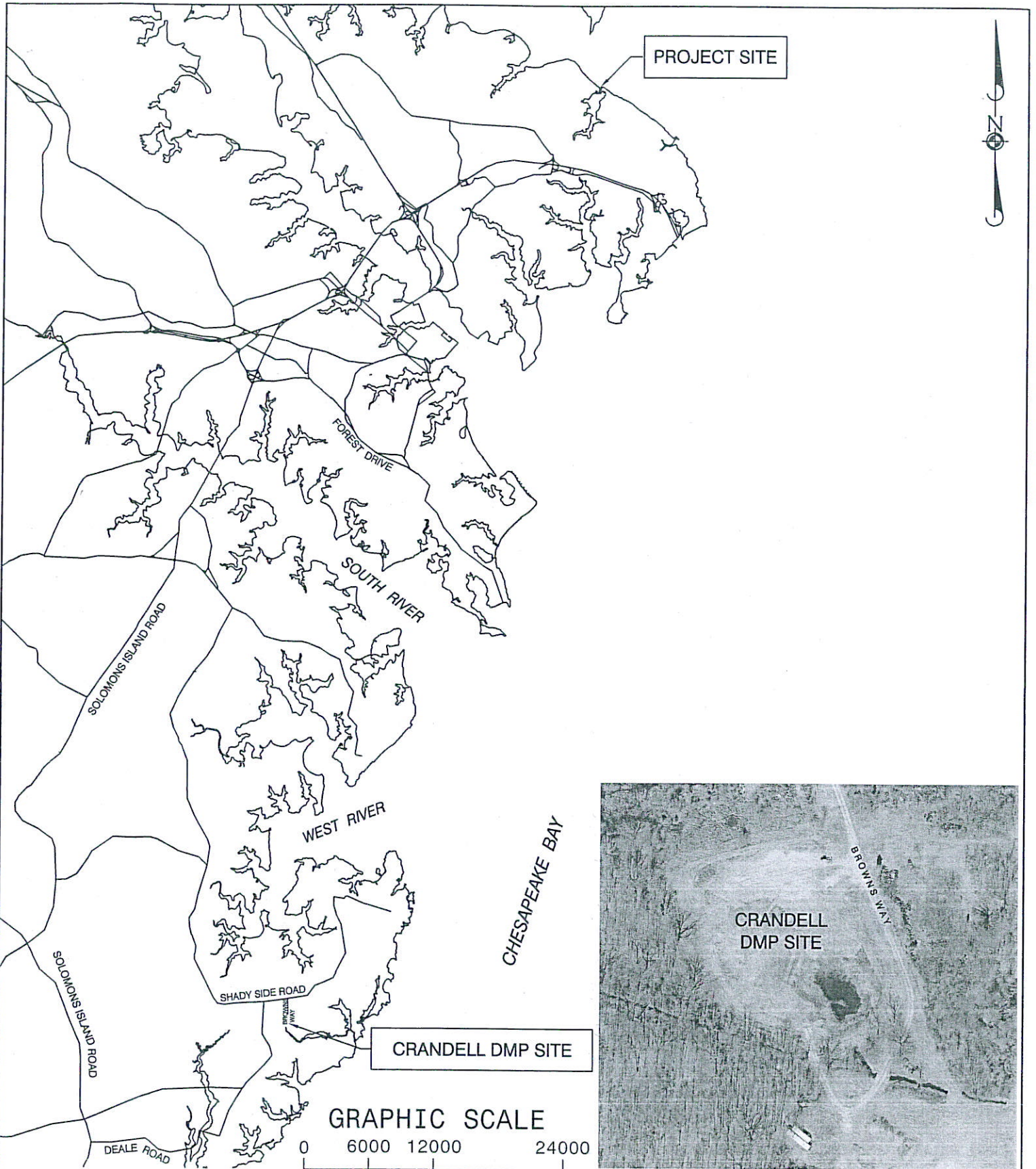

( IN FEET )  
1 inch = 12000feet

12-WL-0590  
201260167

LEGEND	
	PROPOSED CHANNEL
	SHORELINE

**PROPOSED MAINTENANCE DREDGING**  
**LITTLE MAGOTHY RIVER**  
**CAPE SAINT CLAIRE**  
**ANNE ARUNDEL COUNTY, MD**  
**APPL. BY: LITTLE MAGOTHY RIVER ASSOCIATION**  
**DATE: JANUARY 2012 SHEET 1 OF 7**

*BayLand*  
**Consultants & Designers, Inc.**  
*"Integrating Engineering and Environment"*  
 1321 Mercedes Drive, Suite A Phone: (410)694-9401  
 Hanover, Maryland 21076 Fax: (410)694-9405  
 Email: bayland@baylandinc.com  
 Website: http://www.baylandinc.com

**LITTLE MAGOTHY RIVER**  
**VICINITY MAP**  
**JANUARY 26, 2012**



MAGOTHY RIVER  
EBB  
FLOOD

PROPOSED CHANNEL SEGMENT A  
980' x 65' TO -6.0' MLW

SHEET 4 SHEET 5

PROPOSED MAINTENANCE DREDGING.  
ENTIRE CHANNEL PREVIOUSLY  
PERMITTED AND DREDGED UNDER  
CENAB-OP-R (AA DPW/LITTLE MAGOTHY  
RIVER/DREDGED) 01-63542-1 VALID  
THRU 06/17/2012 AND 01-WL-1614 (R)  
VALID THROUGH 08/01/2007

PROPOSED CHANNEL SEGMENT B  
165' x 50' TO -6.0' MLW

CAPE SAINT CLAIRE  
IMP ASSOCIATION

PROPOSED CHANNEL SEGMENT C  
58' x 50' TO -6.0' MLW

WILLIAM COLLINS JR.  
1305 BAY HEAD RD  
ANNAPOLIS, MD 21409

SHEET 3 SHEET 4

PROPOSED CHANNEL SEGMENT D  
528' x 25' to 50' TO -5.0' MLW

LITTLE MAGOTHY RIVER  
EBB  
FLOOD

GRAPHIC SCALE



( IN FEET )  
1 inch = 300 feet

LEGEND	
	PROPOSED CHANNEL
	SHORELINE

12-WL-0590  
2012 60167

PROPOSED MAINTENANCE DREDGING  
LITTLE MAGOTHY RIVER  
CAPE SAINT CLAIRE  
ANNE ARUNDEL COUNTY, MD  
APPL. BY: LITTLE MAGOTHY RIVER  
ASSOCIATION  
DATE: JANUARY 2012 SHEET 2 OF 7

*BayLand*  
Consultants & Designers, Inc.  
"Integrating Engineering and Environment"  
1321 Mercedes Drive, Suite A Phone: (410)694-9401  
Hanover, Maryland 21076 Fax: (410)694-9405  
Email: bayland@baylandinc.com  
Website: http://www.baylandinc.com

LITTLE MAGOTHY RIVER  
JANUARY 26, 2012

CAPE SAINT CLAIRE  
IMP ASSOCIATION

WILLIAM COLLINS JR.  
1305 BAY HEAD RD  
ANNAPOLIS, MD 21409

PROPOSED MAINTENANCE DREDGING.  
ENTIRE CHANNEL PREVIOUSLY  
PERMITTED AND DREDGED UNDER  
CENAB-OP-R (AA DPW/LITTLE MAGOTHY  
RIVER/DREDGED) 01-63542-1 VALID  
THRU 06/17/2012 AND 01-WL-1614 (R)  
VALID THROUGH 08/01/2007

PROPOSED CHANNEL SEGMENT D  
528' x 25' to 50' TO -5.0' MLW

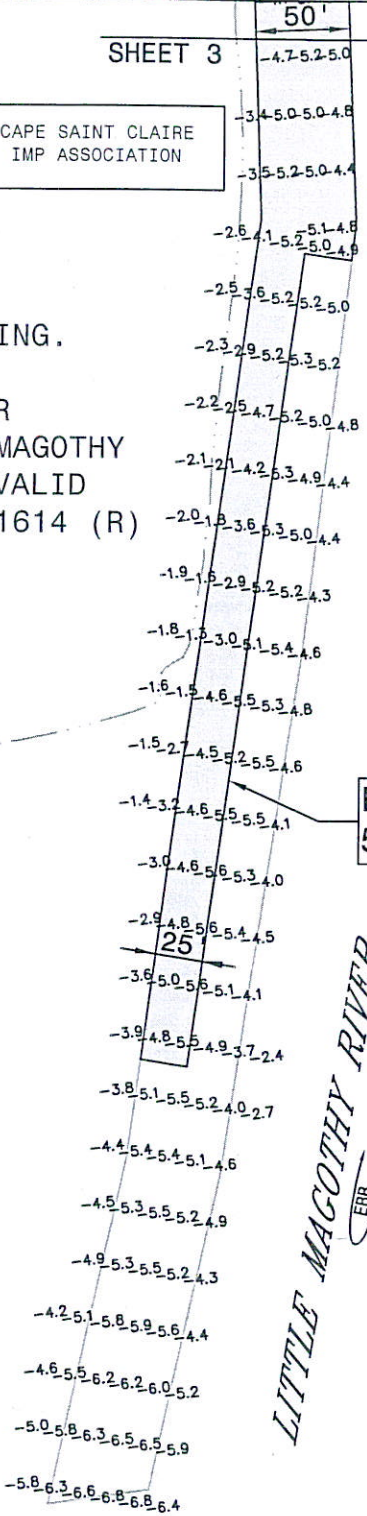

LITTLE MAGOTHY RIVER  
EBB  
FLOOD

GRAPHIC SCALE

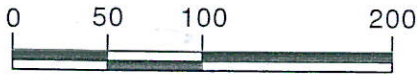

( IN FEET )  
1 inch = 100 feet

12-WL-0590  
201260167

LEGEND	
	PROPOSED CHANNEL
	-3.6 SOUNDINGS BY BAYLAND
	SHORELINE

PROPOSED MAINTENANCE DREDGING

LITTLE MAGOTHY RIVER  
CAPE SAINT CLAIRE  
ANNE ARUNDEL COUNTY, MD  
APPL. BY: LITTLE MAGOTHY RIVER  
ASSOCIATION  
DATE: JANUARY 2012 SHEET 3 OF 7

**Bayland**  
Consultants & Designers, Inc.  
"Integrating Engineering and Environment"  
1321 Mercedes Drive, Suite A Phone: (410)694-9401  
Hanover, Maryland 21076 Fax: (410)694-9405  
Email: bayland@baylandinc.com  
Website: http://www.baylandinc.com

LITTLE MAGOTHY RIVER  
JANUARY 26, 2012



PROPOSED CHANNEL SEGMENT A  
980' x 65' TO -6.0' MLW

PROPOSED CHANNEL SEGMENT B  
165' x 50' TO -6.0' MLW

CAPE SAINT CLAIRE  
IMP ASSOCIATION

PROPOSED MAINTENANCE DREDGING.  
ENTIRE CHANNEL PREVIOUSLY  
PERMITTED AND DREDGED UNDER  
CENAB-OP-R (AA DPW/LITTLE MAGOTHY  
RIVER/DREDGED) 01-63542-1 VALID  
THRU 06/17/2012 AND 01-WL-1614 (R)  
VALID THROUGH 08/01/2007

PROPOSED CHANNEL SEGMENT C  
58' x 50' TO -6.0' MLW

WILLIAM COLLINS JR.  
1305 BAY HEAD RD  
ANNAPOLIS, MD 21409

PROPOSED CHANNEL SEGMENT D  
528' x 25' to 50' TO -5.0' MLW

TIMBER BULKHEAD AND JETTY

TIMBER BULKHEAD AND JETTY  
CONSTRUCTED UNDER 01-GL-358

50' SHEET 4

SHEET 3

GRAPHIC SCALE

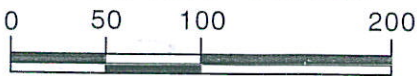

( IN FEET )

1 inch = 100 feet

12-WL-0590  
201260167

LEGEND	
	PROPOSED CHANNEL
	-3.6 SOUNDINGS BY BAYLAND
	SHORELINE

PROPOSED MAINTENANCE DREDGING

LITTLE MAGOTHY RIVER  
CAPE SAINT CLAIRE  
ANNE ARUNDEL COUNTY, MD

APPL. BY: LITTLE MAGOTHY RIVER  
ASSOCIATION

DATE: JANUARY 2012 SHEET 4 OF 7

*Bayland*  
Consultants & Designers, Inc.  
"Integrating Engineering and Environment"  
1321 Mercedes Drive, Suite A Phone: (410)694-9401  
Hanover, Maryland 21076 Fax: (410)694-9405  
Email: bayland@baylandinc.com  
Website: http://www.baylandinc.com

LITTLE MAGOTHY RIVER

JANUARY 26, 2012

# MAGOTHY RIVER

EBB  
FLOOD

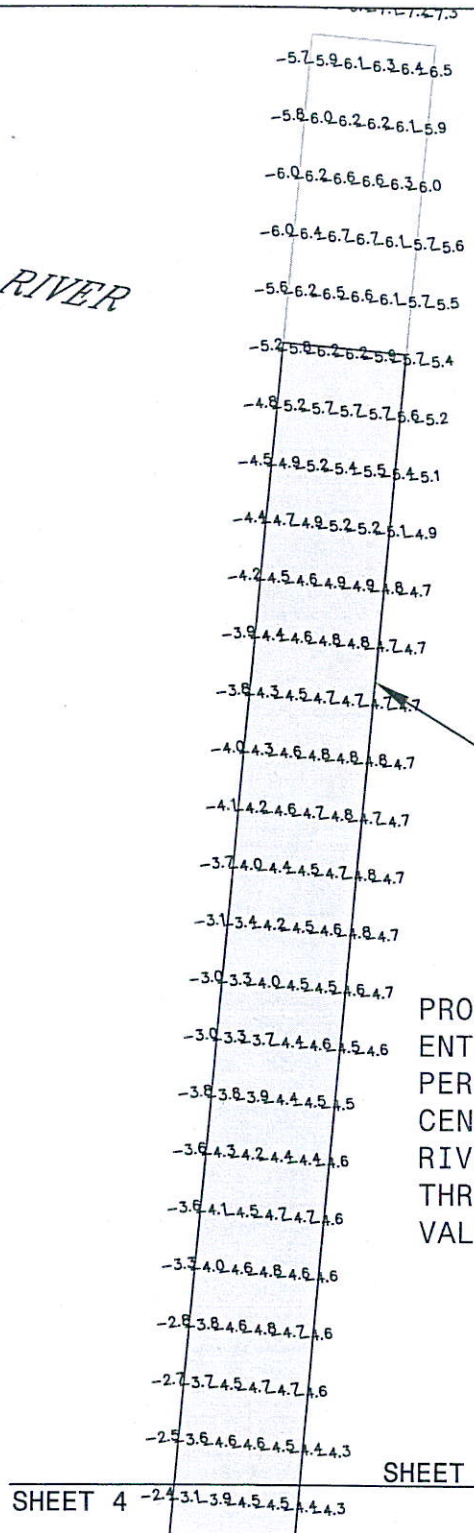

PROPOSED CHANNEL SEGMENT A  
980' x 65' TO -6.0' MLW

PROPOSED MAINTENANCE DREDGING.  
ENTIRE CHANNEL PREVIOUSLY  
PERMITTED AND DREDGED UNDER  
CENAB-OP-R (AA DPW/LITTLE MAGOTHY  
RIVER/DREDGED) 01-63542-1 VALID  
THRU 06/17/2012 AND 01-WL-1614 (R)  
VALID THROUGH 08/01/2007

SHEET 4 -2.4 3.1 3.9 4.5 4.5 4.4 4.3

SHEET 5

## GRAPHIC SCALE



( IN FEET )

1 inch = 100 feet

12-WL-0590  
201260167

LEGEND	
	PROPOSED CHANNEL
	-3.6 SOUNDINGS BY BAYLAND
	SHORELINE

### PROPOSED MAINTENANCE DREDGING

LITTLE MAGOTHY RIVER  
CAPE SAINT CLAIRE  
ANNE ARUNDEL COUNTY, MD

APPL. BY: LITTLE MAGOTHY RIVER  
ASSOCIATION

DATE: JANUARY 2012 SHEET 5 OF 7

**BayLand**  
Consultants & Designers, Inc.  
"Integrating Engineering and Environment"  
1321 Mercedes Drive, Suite A Phone: (410)694-9401  
Hanover, Maryland 21076 Fax: (410)694-9405  
Email: bayland@baylandinc.com  
Website: http://www.baylandinc.com

### LITTLE MAGOTHY RIVER

JANUARY 26, 2012

# TYPICAL CHANNEL SECTIONS

N.T.S.

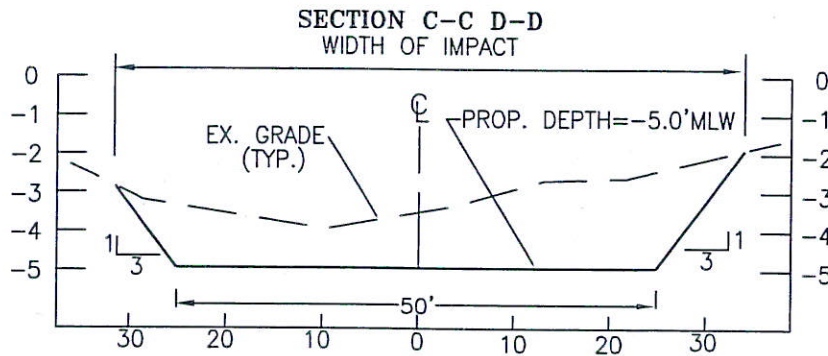
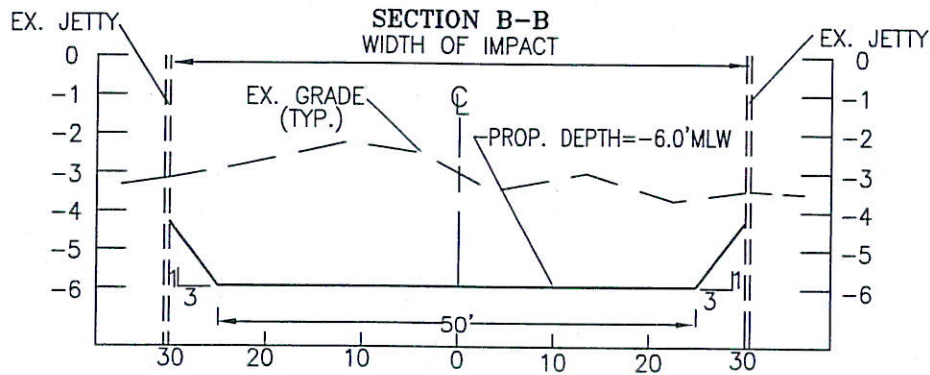
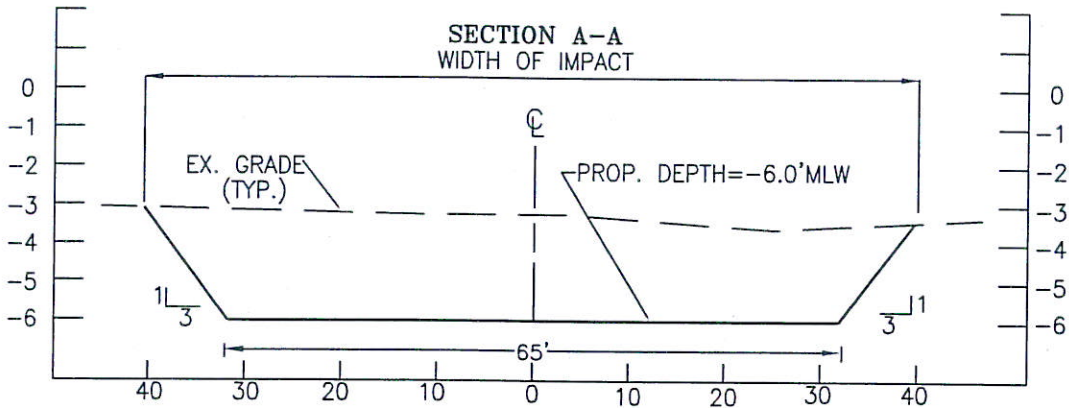

PROPOSED MAINTENANCE DREDGING

LITTLE MAGOTHY RIVER  
CAPE SAINT CLAIRE  
ANNE ARUNDEL COUNTY, MD

APPL. BY: LITTLE MAGOTHY RIVER  
ASSOCIATION

DATE: JANUARY 2012 SHEET 6 OF 7

*Bayland*  
Consultants & Designers, Inc.  
"Integrating Engineering and Environment"  
1321 Mercedes Drive, Suite A Phone: (410)694-9401  
Hanover, Maryland 21076 Fax: (410)694-9405  
Email: bayland@baylandinc.com  
Website: http://www.baylandinc.com

LITTLE MAGOTHY RIVER

JANUARY 26, 2012

12-WL-0590  
201260167

## CHANNEL DATA

SEGMENT	LENGTH (FT)	WIDTH (FT)	DEPTH (MLW)
SEGMENT A	980	65	-6.0'
SEGMENT B	165	50	-6.0'
SEGMENT C	58	50	-5.0'
SEGMENT D	528	<del>25 TO 50</del>	-5.0'
TOTAL CHANNEL VOLUME		6,000 CY	
TOTAL CHANNEL LENGTH		1,731 LF	
TOTAL CHANNEL AREA OF IMPACT		92,824 SF = 2.1 AC	

**NOTES:**

1. BASEMAP COMPILED FROM MARYLAND DEPARTMENT OF NATURAL RESOURCES
2. SOUNDING DATA PROVIDED BY BAYLAND CONSULTANTS DATED 12/19/2011
3. SOUNDINGS ARE IN FEET AND REFER TO MLW.
4. TIDAL RANGE IN 0.8'
5. THESE ARE PERMIT DRAWINGS ONLY. DESIGN DRAWINGS WILL BE PREPARED SEPARATELY.

*12-WL-0590  
201260167*

**PROPOSED MAINTENANCE DREDGING**

LITTLE MAGOTHY RIVER  
CAPE SAINT CLAIRE  
ANNE ARUNDEL COUNTY, MD

APPL. BY: LITTLE MAGOTHY RIVER  
ASSOCIATION

DATE: JANUARY 2012 SHEET 7 OF 7

 <b>Bayland</b> Consultants & Designers, Inc. <small>"Integrating Engineering and Environment"</small>	Phone: (410)694-9401 Fax: (410)694-9405 <small>Email: bayland@baylandinc.com                  Website: http://www.baylandinc.com</small>
1321 Mercedes Drive, Suite A Hanover, Maryland 21076	

LITTLE MAGOTHY RIVER

JANUARY 26, 2012